

Model: ENERGY
ET38
EHB38

SPECIFICATIONS:
 Year of Intro 2000
 Thrust 38LBS
 Volts 12VDC
 Amp Draw 0 to 48 amps
 Mount 03 Transom
 or 01 BOW
 Speeds 5/2

PARTS ORDERING & TECH ASSISTANCE
 MotorGuide Consumer Relations
 Phone 918-831-6989
 Fax 800-982-8093

Returned Goods must be accompanied with a Returned Goods Authorization. Contact MotorGuide Consumer Relations to obtain RGA.

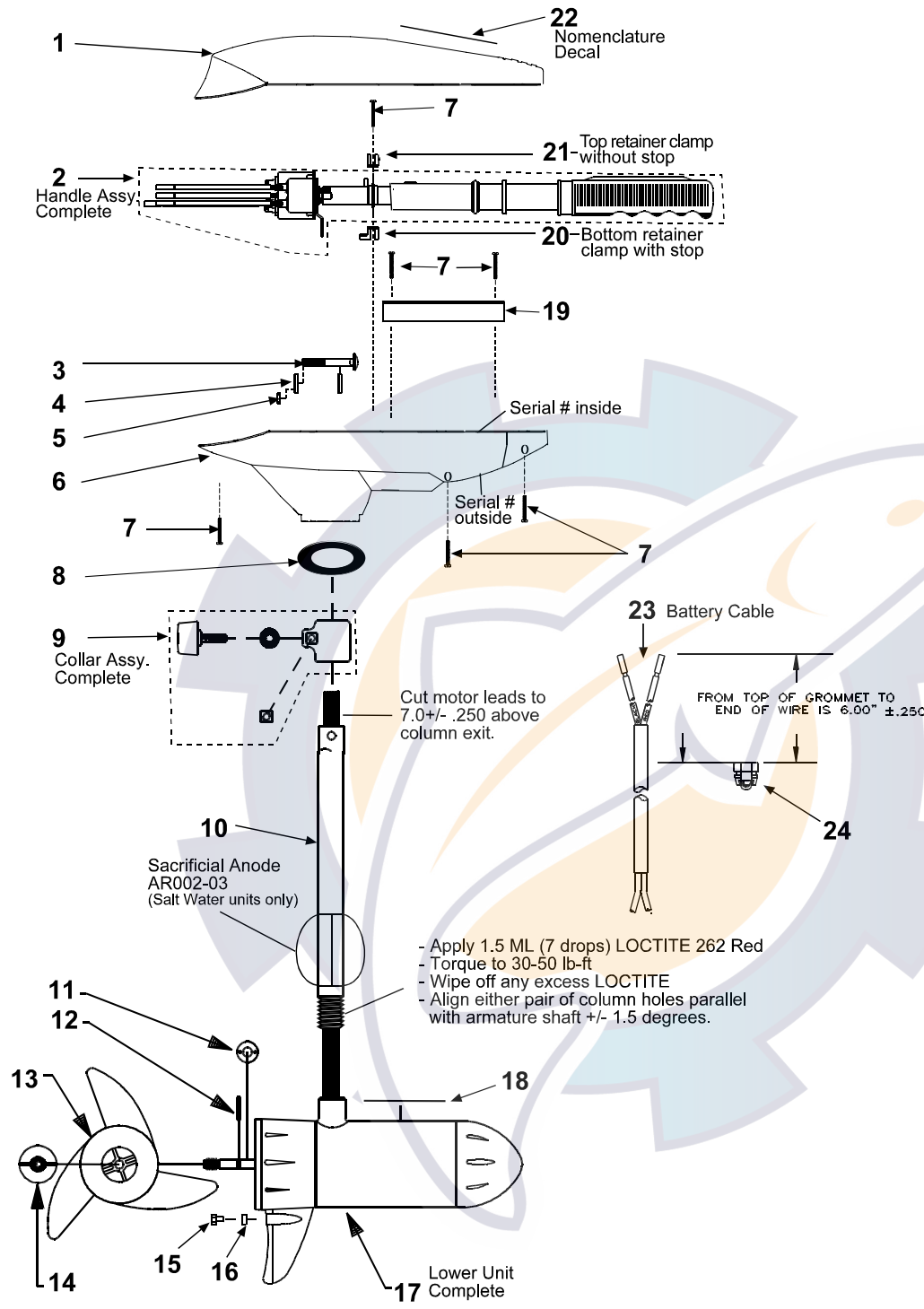

KEY	DESCRIPTION	PART #	KEY	DESCRIPTION	PART #	KEY	DESCRIPTION	PART #
1	TOP HOUSING COVER BLACK	ET053-17	11	MONOFILAMENT WASHER	AR175-01	22	NOMENCLATURE DECAL	AT056-22
2	HANDLE ASY	BT372-09	12	PROP DRIVE PIN	BR102-01		ET38	AT056-22
3	BOLT	TT134-02	13	PROP/3 BLADE	AF124-12		EHB38	PT056-21
4	CURVED WASHER	TT171-08		PROP/2 BLADE	AF124-07	23	BATTERY CABLE	XT328-06
5	NYLON LOCK NUT	XT098-02	14	PROP NUT	AR099-01	24	GROMMET	GR019-01
6	T/H BASE BLACK	ET004-16	15	ANODE BOLT (Saltwater models only)	DK133-01			
7	#8 X 5/8 SCREW	AT141-01	16	ANODE (Saltwater models only)	AR002-02			
8	COLUMN SEAL	AT079-01	17	MOTOR	PF397-04			
9	DEPTH ADJUSTMENT COLLAR	AR158-01	18	LOWER UNIT DECAL	ET060-08			
10	COLUMN 36"	TT049-05	19	CABLE PLATE	AT155-06			
	COLUMN 42"	TT049-06	20	BOTTOM RETAINER CLAMP	AR036-05			
	COLUMN 50"	FR049-13	21	UPPER RETAINER CLAMP	AR036-04			

